



70-345^{Q&As}

Designing and Deploying Microsoft Exchange Server 2016

Pass Microsoft 70-345 Exam with 100% Guarantee

Free Download Real Questions & Answers **PDF** and **VCE** file from:

<https://www.pass4lead.com/70-345.html>

100% Passing Guarantee
100% Money Back Assurance

Following Questions and Answers are all new published by Microsoft
Official Exam Center

-  **Instant Download** After Purchase
-  **100% Money Back** Guarantee
-  **365 Days** Free Update
-  **800,000+** Satisfied Customers





QUESTION 1

You run Get-Service | where displayname-like *transport* | FT -AutoSize and you receive the following output.

```
Status Name DisplayName
-----
Stopped MExchangeDelivery Microsoft Exchange Mailbox Transport Delivery
Running MExchangeFrontEndTransport Microsoft Exchange Frontend Transport
Running MExchangeSubmission Microsoft Exchange Mailbox Transport Submission
Running MExchangeTransport Microsoft Exchange Transport
Stopped MExchangeTransportLogSearch Microsoft Exchange Transport Log Search
```

Use the drop-down menus to select the answer choice that completes each statement based on the information presented in the output.

Hot Area:

Answer Area

Messages sent to recipients on the server will [answer choice]

Messages sent from mailboxes on the server by using Outlook on the web will [answer choice]

Options for the first dropdown: be rejected, be queued, be delivered to the recipient

Options for the second dropdown: be rejected, remain in the Drafts folder, be delivered to the recipient

Correct Answer:

Answer Area

Messages sent to recipients on the server will [answer choice]

Messages sent from mailboxes on the server by using Outlook on the web will [answer choice]

Options for the first dropdown: be rejected, be queued, be delivered to the recipient

Options for the second dropdown: be rejected, remain in the Drafts folder, be delivered to the recipient

QUESTION 2

You have two standalone Exchange Server 2016 servers.

You perform daily full backups of the Exchange server databases.

A user accidentally deletes some critical items.



You need to restore the critical items.

Which three actions should you perform in sequence? To answer, move the appropriate actions from the list of actions to the answer area and arrange them in the correct order.

Select and Place:

- Install another Exchange Server 2016 server in a temporary organization.
- Run the New-MailboxRestoreRequest cmdlet
- Create a new mailbox database. Move the mailbox of the user to the new mailbox database.
- Restore the mailbox database.
- Run the New-MailboxDatabase cmdlet and specify the -Recovery switch.

Correct Answer:

- | | |
|--|--|
| Install another Exchange Server 2016 server in a temporary organization. | Create a new mailbox database. Move the mailbox of the user to the new mailbox database. |
| | Restore the mailbox database. |
| | Run the New-MailboxRestoreRequest cmdlet |
| Run the New-MailboxDatabase cmdlet and specify the -Recovery switch. | |

QUESTION 3

Your company has an Exchange Server 2016 organization. The organization has a four-node database availability group (DAG) that spans two data centers. Each data center is configured as a separate Active Directory site. The data centers

connect to each other by using a high-speed WAN link. Each data center connects directly to the Internet and has a scoped Send connector configured.



The company's public DNS zone contains one MX record.

You need to ensure that if an Internet link becomes unavailable in one data center, email messages destined to external recipients can be routed through the other data center.

What should you do?

- A. Create a Receive connector in each data center.
- B. Clear the Proxy through Client Access server check box.
- C. Clear the Scoped Send Connector check box.
- D. Create an MX record in the internal DNS zone.

Correct Answer: C

QUESTION 4

You plan to deploy a data availability group (DAG) across two locations. You will use a Microsoft Azure virtual machine as a witness server.

You need to configure the network infrastructure to support the planned deployment.

Which three actions should you perform in sequence? To answer, move the appropriate actions from the list of actions to the answer area and arrange them in the correct order.

Select and Place:

Actions

- Configure on-premises VPN devices.
- Configure an Azure load balancer.
- Configure public endpoints for the cloud service.
- In Azure, deploy a point-to-site VPN.
- In Azure, deploy a multi-site VPN.
- In Azure, create a logical network object for a data center, and register the on-premises servers.

Answer Area

Correct Answer:

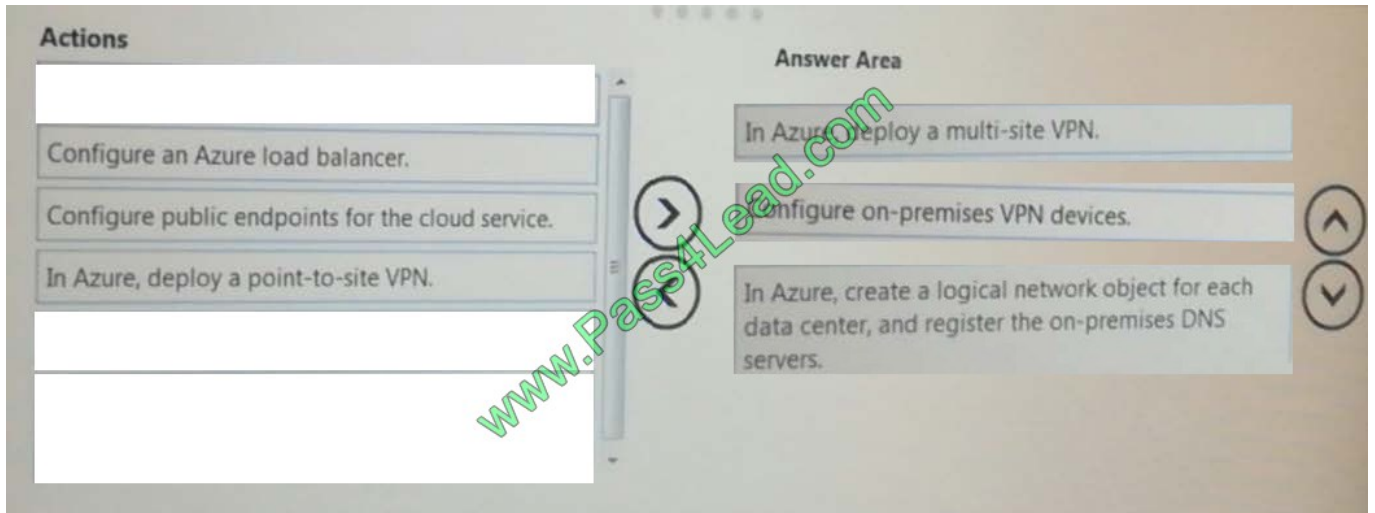

QUESTION 5

HOTSPOT

You have an Exchange Server 2010 organization.

You plan to upgrade to Exchange Server 2016.

You have two active directory sites configured as shown in the following table.

Site Name	Internet-facing
Brussels	No
New York	Yes

You have five servers configured as shown in the following table.



Server name	Exchange Server version	Role	Active Directory site
EX01	2010	Mailbox server	Brussels
CAS01	2010	Client Access server, Hub Transport server	Brussels
EX02	2010	Mailbox server	Brussels
CAS02	2010	Client Access server, Hub Transport server	New York
EX03	2016	Mailbox server	New York

You have three users who have mailboxes configured as shown in the following table.

User Name	Mailbox server location
User1	EX01
User2	EX02
User3	EX03

You have the following configurations:

The OWA virtual directory ExternalURL on CAS01 is <https://mail.brussels.contoso.com/owa>.

The OWA virtual directory ExternalURL on CAS02 is \$null.

The OWA virtual directory ExternalURL on EX03 is <https://mail.contoso.com/owa>.

All users connect to <https://mail.contoso.com/owa> to access Outlook on the web.

For each of the following statements, select Yes, if the statement is true. Otherwise, select No.

Hot Area:



Statements	Yes	No
User1 will be redirected to CAS01 when accessing Outlook on the web from the Internet.	<input type="radio"/>	<input type="radio"/>
User2 will be redirected to CAS02 when accessing Outlook on the web from the Internet.	<input type="radio"/>	<input type="radio"/>
User3 will be proxied to CAS02 when accessing Outlook on the web from the Internet.	<input type="radio"/>	<input type="radio"/>

Correct Answer:

Statements	Yes	No
User1 will be redirected to CAS01 when accessing Outlook on the web from the Internet.	<input checked="" type="radio"/>	<input type="radio"/>
User2 will be redirected to CAS02 when accessing Outlook on the web from the Internet.	<input checked="" type="radio"/>	<input type="radio"/>
User3 will be proxied to CAS02 when accessing Outlook on the web from the Internet.	<input type="radio"/>	<input checked="" type="radio"/>

[70-345 PDF Dumps](#)

[70-345 Study Guide](#)

[70-345 Exam Questions](#)



To Read the [Whole Q&As](#), please purchase the [Complete Version](#) from [Our website](#).

Try our product !

100% Guaranteed Success

100% Money Back Guarantee

365 Days Free Update

Instant Download After Purchase

24x7 Customer Support

Average 99.9% Success Rate

More than 800,000 Satisfied Customers Worldwide

Multi-Platform capabilities - [Windows](#), [Mac](#), [Android](#), [iPhone](#), [iPod](#), [iPad](#), [Kindle](#)

We provide exam PDF and VCE of Cisco, Microsoft, IBM, CompTIA, Oracle and other IT Certifications. You can view Vendor list of All Certification Exams offered:

<https://www.pass4lead.com/allproducts>

Need Help

Please provide as much detail as possible so we can best assist you.

To update a previously submitted ticket:

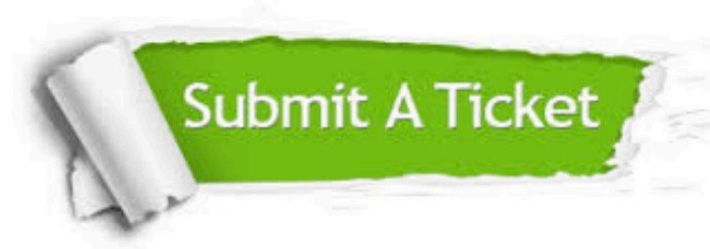

 <p>One Year Free Update Free update is available within One Year after your purchase. After One Year, you will get 50% discounts for updating. And we are proud to boast a 24/7 efficient Customer Support system via Email.</p>	 <p>Money Back Guarantee To ensure that you are spending on quality products, we provide 100% money back guarantee for 30 days from the date of purchase.</p>	 <p>Security & Privacy We respect customer privacy. We use McAfee's security service to provide you with utmost security for your personal information & peace of mind.</p>
---	---	--

Any charges made through this site will appear as Global Simulators Limited.

All trademarks are the property of their respective owners.

Copyright © pass4lead, All Rights Reserved.