



AZ-203^{Q&As}

Developing Solutions for Microsoft Azure

Pass Microsoft AZ-203 Exam with 100% Guarantee

Free Download Real Questions & Answers **PDF** and **VCE** file from:

<https://www.pass4lead.com/az-203.html>

100% Passing Guarantee
100% Money Back Assurance

Following Questions and Answers are all new published by Microsoft
Official Exam Center

-  **Instant Download** After Purchase
-  **100% Money Back** Guarantee
-  **365 Days** Free Update
-  **800,000+** Satisfied Customers





QUESTION 1

DRAG DROP

You are deploying an Azure Kubernetes Services (AKS) cluster that will use multiple containers

You need to create the cluster and verify that the services for the containers are configured correctly and available.

Which four commands should you use to develop the solution? To answer, move the appropriate command segments from the list of command segments to the answer area and arrange them in the correct order.

Select and Place:

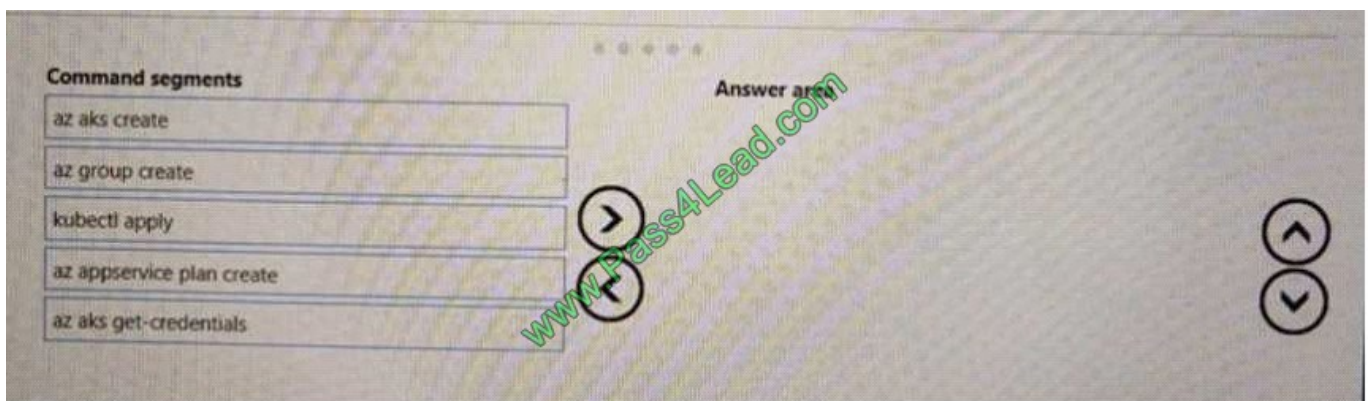

Correct Answer:

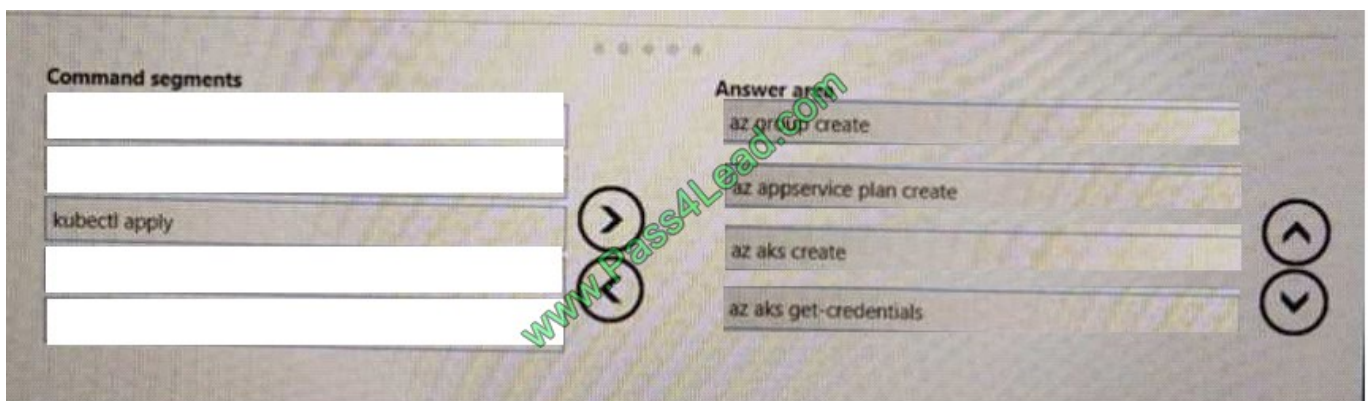

QUESTION 2

DRAG DROP

Your company has several websites that use a company logo image. You use Azure Content Delivery Network (CDN) to store the static image.

You need to determine the correct process of how the CDN and the Point of Presence (POP) server will distribute the image and list the items in the correct order.



In which order do the actions occur? To answer, move all actions from the list of actions to the answer area and arrange them in the correct order.

Select and Place:

Actions

- The origin server returns the logo image to an edge server in the POP. An edge server in the POP caches the logo image and returns the image to the client.
- If no edge servers in the POP have the image in cache, the POP requests the file from the origin server.
- A user requests the image from the CDN URL. The DNS routes the request to the best performing POP location.
- Subsequent requests for the file may be directed to the same POP using the CDN logo image URL. The POP edge server returns the file from cache if the TTL has not expired.

Answer area

Correct Answer:

Actions

Answer area

- Subsequent requests for the file may be directed to the same POP using the CDN logo image URL. The POP edge server returns the file from cache if the TTL has not expired.
- If no edge servers in the POP have the image in cache, the POP requests the file from the origin server.
- The origin server returns the logo image to an edge server in the POP. An edge server in the POP caches the logo image and returns the image to the client.
- A user requests the image from the CDN URL. The DNS routes the request to the best performing POP location.

QUESTION 3

DRAG DROP

You develop a web app that uses the tier D1 app service plan by using the Web Apps feature of Microsoft Azure App Service.

Spikes in traffic have caused increases in page load times.

You need to ensure that the web app automatically scales when CPU load is about 85 percent and minimize costs.

Which four actions should you perform in sequence? To answer, move the appropriate actions from the list of actions to the answer area and arrange them in the correct order.



Select and Place:

Actions

- Enable autoscaling on the web app.
- Configure a Scale condition.
- Configure the web app to the Standard App Service tier
- Configure the web app to the Premium App Service tier
- Switch to an Azure App Services consumption plan.
- Add a Scale rule.

Answer Area

Answer Area interface showing a vertical list of actions with up and down arrows for reordering. The actions are: Configure the web app to the Standard App Service tier, Enable autoscaling on the web app, Add a Scale rule, and Configure a Scale condition.

Correct Answer:

Actions

- Configure the web app to the Premium App Service tier
- Switch to an Azure App Services consumption plan.

Answer Area

Answer Area interface showing a vertical list of actions with up and down arrows for reordering. The actions are: Configure the web app to the Standard App Service tier, Enable autoscaling on the web app, Add a Scale rule, and Configure a Scale condition.

Explanation: Step 1: Configure the web app to the Standard App Service Tier The Standard tier supports auto-scaling, and we should minimize the cost. Step 2: Enable autoscaling on the web app First enable autoscale Step 3: Add a scale rule Step 4: Add a Scale condidation References:

<https://docs.microsoft.com/en-us/azure/monitoring-and-diagnostics/monitoringautoscale-get-started>
<https://azure.microsoft.com/en-us/pricing/details/app-service/plans/>

QUESTION 4

DRAG DROP

You are developing an ASP.NET Core Web API web service that uses Azure Application Insights to monitor performance and trade events.

You need to enable logging and ensure that log messages can be correlated to events tracked by Application Insights.

How should you complete the code? To answer, drag the appropriate code segments to the correct locations. Each code segment may be used once, more than once, or not at all. You may need to drag the split bar between panes or scroll to

view content.



NOTE: Each correct selection is worth one point.

Select and Place:

Code segments

- IncludeEventId
- ServerFeatures
- LoggerFilterOptions
- ApplicationServices
- ApplicationInsightsLoggerOptions
- TrackExceptionsAsExceptionTelemetry

Answer Area

```

public class Startup
{
    ...
    public void ConfigureServices(IServiceCollection services)
    {
        services.AddOptions<code segment>()<code segment>().
        ConfigureServices(o => o. code segment = true );
        services.AddMvc();
    }

    public void Configure(IApplicationBuilder app,
        IHostingEnvironment env, ILoggerFactory loggerFactory)
    {
        loggerFactory.AddApplicationInsights(app. code segment , LogLevel.Trace);
        app.UseMvc();
    }
}

```

Correct Answer:

Code segments

- IncludeEventId
- ServerFeatures
- LoggerFilterOptions
- ApplicationServices
- ApplicationInsightsLoggerOptions
- TrackExceptionsAsExceptionTelemetry

Answer Area

```

public class Startup
{
    ...
    public void ConfigureServices(IServiceCollection services)
    {
        services.AddOptions<ServerFeatures>()ApplicationInsightsLoggerOptions().
        ConfigureServices(o => o. ApplicationInsightsLoggerOptions = true );
        services.AddMvc();
    }

    public void Configure(IApplicationBuilder app,
        IHostingEnvironment env, ILoggerFactory loggerFactory)
    {
        loggerFactory.AddApplicationInsights(app. IncludeEventId , LogLevel.Trace);
        app.UseMvc();
    }
}

```

QUESTION 5

HOTSPOT

You are creating an app that uses Event Grid to connect with other services. Your app's event data will be sent to a serverless function that checks compliance. This function is maintained by your company.

You write a new event subscription at the scope of your resource. The event must be invalidated after 3 specific period of time. You need to configure Event Grid to ensure security.

What should you implement? To answer, select the appropriate options in the answer area;

NOTE: Each correct selection is worth one point

Hot Area:



Authentication

Type

WebHook event delivery

	▼
SAS tokens	
Key authentication	
JWT token	

Topic publishing

	▼
ValidationCode handshake	
ValidationURL handshake	
Management Access Control	

Correct Answer:

Authentication

Type

WebHook event delivery

	▼
SAS tokens	
Key authentication	
JWT token	

Topic publishing

	▼
ValidationCode handshake	
ValidationURL handshake	
Management Access Control	

Box 1: SAS tokens

Custom topics use either Shared Access Signature (SAS) or key authentication.

Microsoft recommends SAS, but key authentication provides simple programming, and is compatible with many existing webhook publishers.

In this case we need the expiration time provided by SAS tokens.



Box 2: ValidationCode handshake

Event Grid supports two ways of validating the subscription: ValidationCode handshake (programmatic) and ValidationURL handshake (manual).

If you control the source code for your endpoint, this method is recommended.

Incorrect Answers:

ValidationURL handshake (manual): In certain cases, you can't access the source code of the endpoint to implement the ValidationCode handshake. For example, if you use a third-party service (like Zapier or IFTTT), you can't programmatically respond with the validation code.

References:

<https://docs.microsoft.com/en-us/azure/event-grid/security-authentication>

[Latest AZ-203 Dumps](#)

[AZ-203 Practice Test](#)

[AZ-203 Study Guide](#)



To Read the [Whole Q&As](#), please purchase the [Complete Version](#) from [Our website](#).

Try our product !

100% Guaranteed Success

100% Money Back Guarantee

365 Days Free Update

Instant Download After Purchase

24x7 Customer Support

Average 99.9% Success Rate

More than 800,000 Satisfied Customers Worldwide

Multi-Platform capabilities - [Windows](#), [Mac](#), [Android](#), [iPhone](#), [iPod](#), [iPad](#), [Kindle](#)

We provide exam PDF and VCE of Cisco, Microsoft, IBM, CompTIA, Oracle and other IT Certifications. You can view Vendor list of All Certification Exams offered:

<https://www.pass4lead.com/allproducts>

Need Help

Please provide as much detail as possible so we can best assist you.

To update a previously submitted ticket:

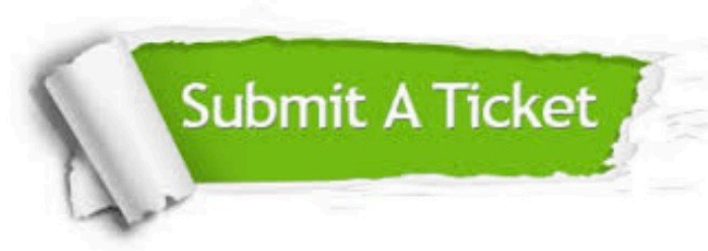

 <p>One Year Free Update Free update is available within One Year after your purchase. After One Year, you will get 50% discounts for updating. And we are proud to boast a 24/7 efficient Customer Support system via Email.</p>	 <p>Money Back Guarantee To ensure that you are spending on quality products, we provide 100% money back guarantee for 30 days from the date of purchase.</p>	 <p>Security & Privacy We respect customer privacy. We use McAfee's security service to provide you with utmost security for your personal information & peace of mind.</p>
---------------------------------------------------------------------------------------------------------------------------------------------------------------------------------------------------------------------------------------------------------------------------------------------------------------------------------	-------------------------------------------------------------------------------------------------------------------------------------------------------------------------------------------------------------------------------------------------------------	------------------------------------------------------------------------------------------------------------------------------------------------------------------------------------------------------------------------------------------------------------------------------------

Any charges made through this site will appear as Global Simulators Limited.

All trademarks are the property of their respective owners.

Copyright © pass4lead, All Rights Reserved.